

DS-K4H250S

Single-door Magnetic Lock

- Supports 300 kg Static Linear Thrust
- 12 VDC (default) or 24 VDC
- Internal Voltage Dependent Resistor (MOV)
- Door Lock Status Signal Output (NO\NC\COM)
- For Wooden, Glass, Metal, and Fireproof Doors



Hikvision's DS-K4H250S Single-Door Magnetic Lock is designed for wooden doors, glass doors, and steel doors with 90° opening angles. The maximum thrust of the lock is 300 kg. It can be used for controlling door opening/closing, and the indicator shows the door status. It supports signal output of door lock output status testing.

Available Models: DS-K4H250S

Circuit Board Diagram

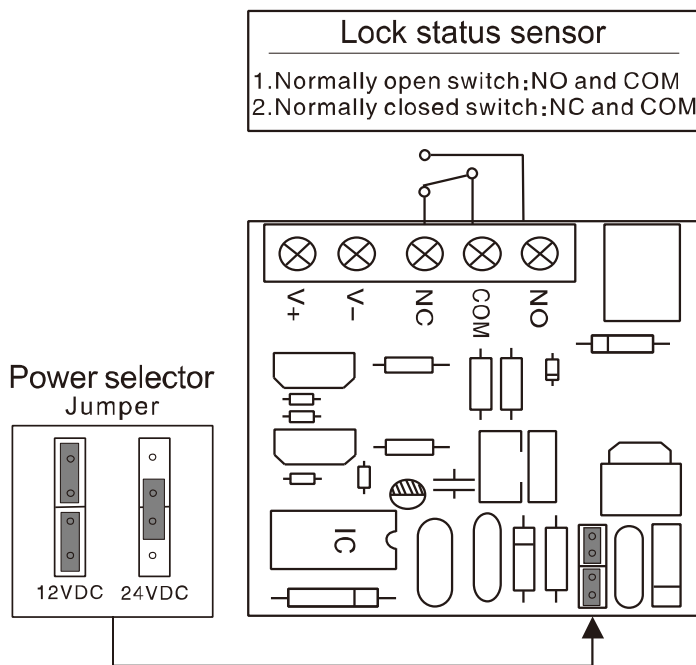

Specifications

DS-K4H250S	
Maximum Thrust	300 kg linear thrust
Input Voltage	12 VDC/24 VDC
Working Current	12 V: 500 mA, 24 V: 250 mA
Signal Output	Dry contact signal output, supports maximum power rate of 3 A, NO output while locking and NC output while unlocking
LED Indicator	Red (door is unlocked), green (door is locked)
Suitable Doors	Wooden door, glass door, metal door, fireproof door
Working Temperature	14° to 131° F (-10° to +55° C)
Working Humidity	0 to 95% relative humidity
Shell	Aluminum alloy
Lock Body	Zinc, electroplated
Armature Plate	Zinc, electroplated
Lock Body Dimensions (L×W×H)	9.45" × 1.93" × 1.00" (240 mm × 49 mm × 25.5 mm)
Armature Plate Dimensions (L×W×H)	7.1" × 1.5" × 0.4" (180 mm × 38 mm × 11 mm)
Weight	4.63 lb (2.1 kg)

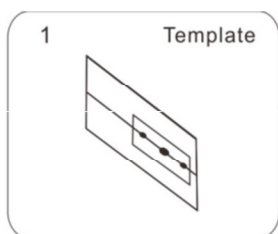
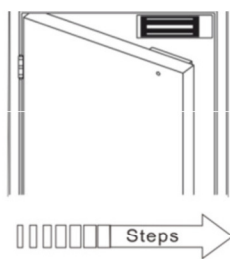

Fold the plate 90°.

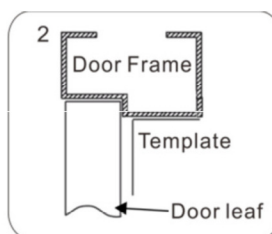

First close the door, then place the upper side of the template on the door frame, while adjusting the left side, next to the door leaf.

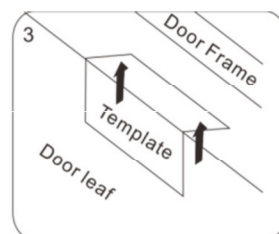

Mark screw positions of armature plate and door magnetic lock on door leaf and frame, respectively.

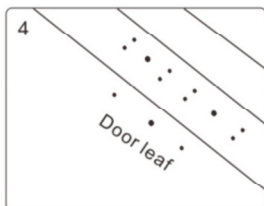

Drill holes based on the marked positions.

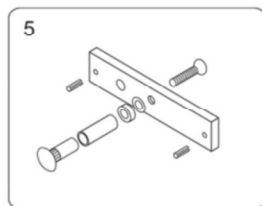

Assemble items based on the picture.

Hollow Metal Door Wooden Door Metal Surface Door

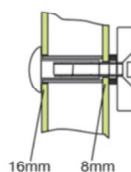

Drill a hole
Inside: Diameter is 8mm
Outside: Diameter is 16mm

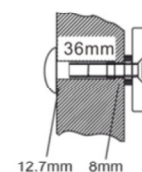

Drill a hole
Inside: Diameter is 8mm
Outside: Diameter is 12.7mm

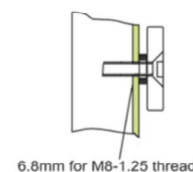

Inside: Drill a hole diameter is 8mm folding the plastic straight pin

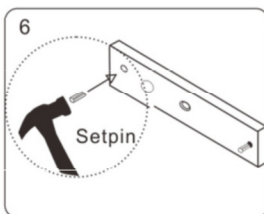

Strike the pin into the armature plate slightly (to avoid movement).

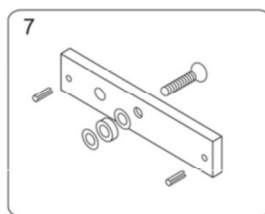

Assemble items based on the picture (add washer accordingly). You must add rubber ring.

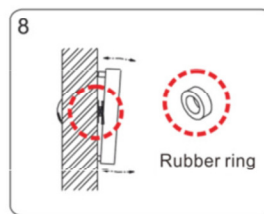

Place the rubber ring between armature plate and door leaf.

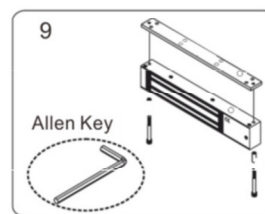

Use Allen key to remove the mounting plate from lock body.

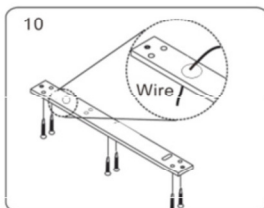

Fix the mounting plate on the door frame according to the holes drilled earlier.

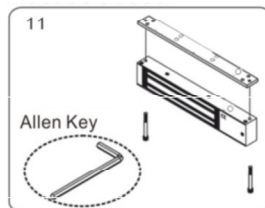

Use Allen key to screw the lock body on the mounting plate.

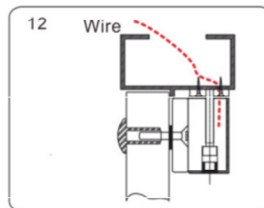

Close the door to test holding force. The angle between armature plate and magnetic lock can be adjusted by adding or reducing washers.

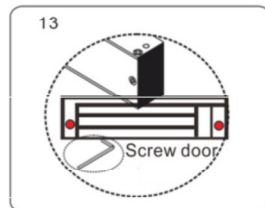

After all the appropriate procedures, the holding force can be maximized. Finally, fix the tamper screw.

Installation Instruction

